

# 2300, 2400, 2500, 2700, 2800 SERIES TWIN HOPPER

Cut detail parts from sprue with a sharp hobby knife  
Use liquid plastic cement for unpainted plastic joints  
and CA/Super Glue or Epoxy on painted parts

**1** Cement BRAKE EQUIPMENT to end of FRAME with brake equipment supports.

**2** Paint WEIGHTS if desired and cement into cavities in underside of BODY. Cement FRAME into BODY with brake equipment in the end with the BRAKE PLATFORM.

**3** Cement the HOPPER DOOR BEAMS into the hopper door notches. Cement DOOR CLOSING MECHANISMS into notches on hopper sides (MORE DETAIL BELOW)

**4** Install your choice of COUPLERS in the boxes on the ends of the frame and attach COUPLER BOX COVERS with COUPLER BOX SCREWS. Couplers are installed properly if you can "shake hands" with them when car is on the track

**5** Assemble TRUCKS AND WHEELS and attach with the truck screws provided.

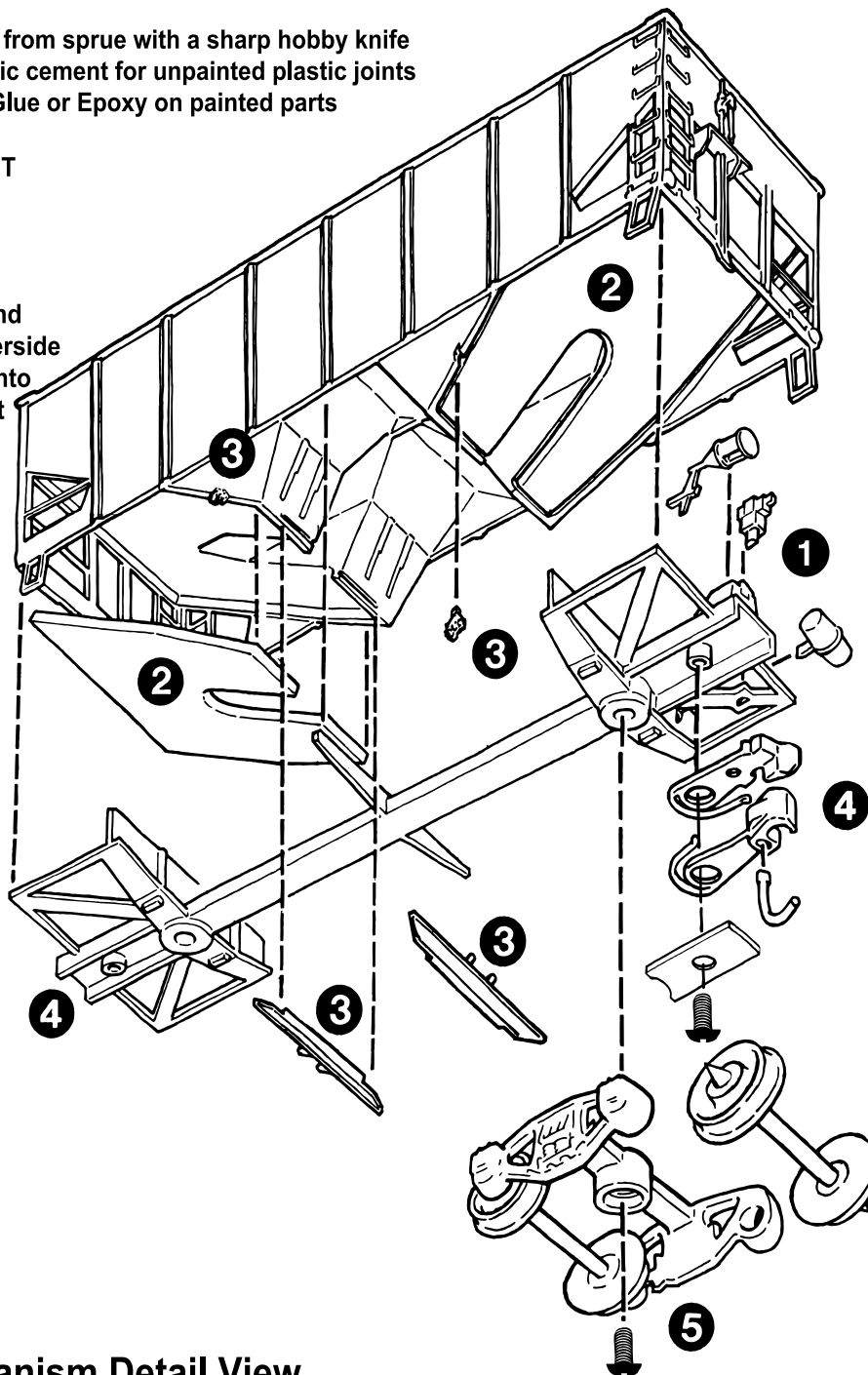

## Door Closing Mechanism Detail View

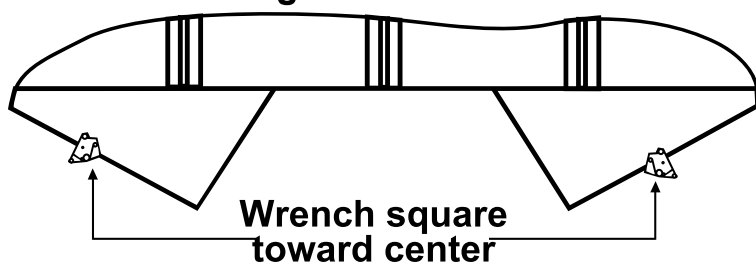

## Brake Detail Assembled View

